

**INVCU Associates, Inc.**  
 ENGINEERING, ARCHITECTURE & PLANNING  
 301 WALLACE STREET, 3RD FLOOR  
 HADDON HEIGHTS, NEW JERSEY 08033  
 TEL: 856-326-8811  
 FAX: 856-326-8812  
 WWW.HADDONHEIGHTS.COM

This map was developed using AEC/Geographic Information Systems (GIS) data and is a necessary product which is not intended to be used for any purpose other than that intended by the original data provider.

**Zoning Map adopted by Ordinance 2013-16**  
 Sources:  
 Parcel Data, Camden County Planning Department  
 Wetlands Data, NJDEP  
 Serial #: 1-10002  
 Date: February 2009  
 New 2009 Water Plan Recommendations  
 Prepared By: Leah Ferry Boudier, P.E., AICP

**Zoning Map adopted by Ordinance 2013-16**  
 Sources:  
 Parcel Data, Camden County Planning Department  
 Wetlands Data, NJDEP  
 Serial #: 1-10002  
 Date: February 2009  
 New 2009 Water Plan Recommendations  
 Prepared By: Leah Ferry Boudier, P.E., AICP

# ZONING MAP

## Clementon Borough

### Camden County, New Jersey

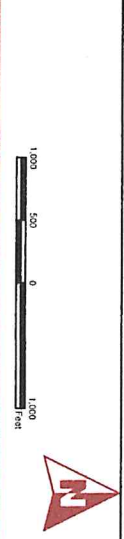

- Legend**
- Redevelopment Areas
  - Highway Commercial
  - Mixed Use
  - Planned Residential
  - Clementon Zoning
    - AP - Amusement Park
    - PO-R/Professional Office/Residential
    - B-1 - Commercial (Central)
    - B-2 - Commercial (Highway)
    - B-3 - Commercial (Regional)
    - M-1 - Light Industrial
    - P - Park Land
    - R-1 - One Family Residential
    - R-2 - One Family Residential
    - R-3 - Garden Apartments
    - PR - Planned Residential
    - R-5 - One Family Residential
  - Municipal Boundary

